

# YAS Events Paddock

## Paddock Suites

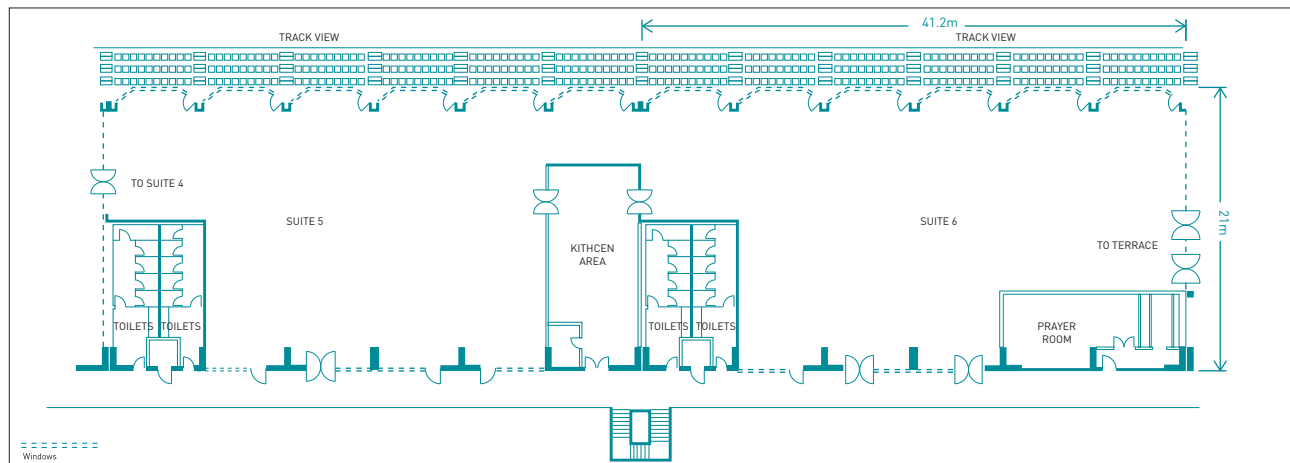
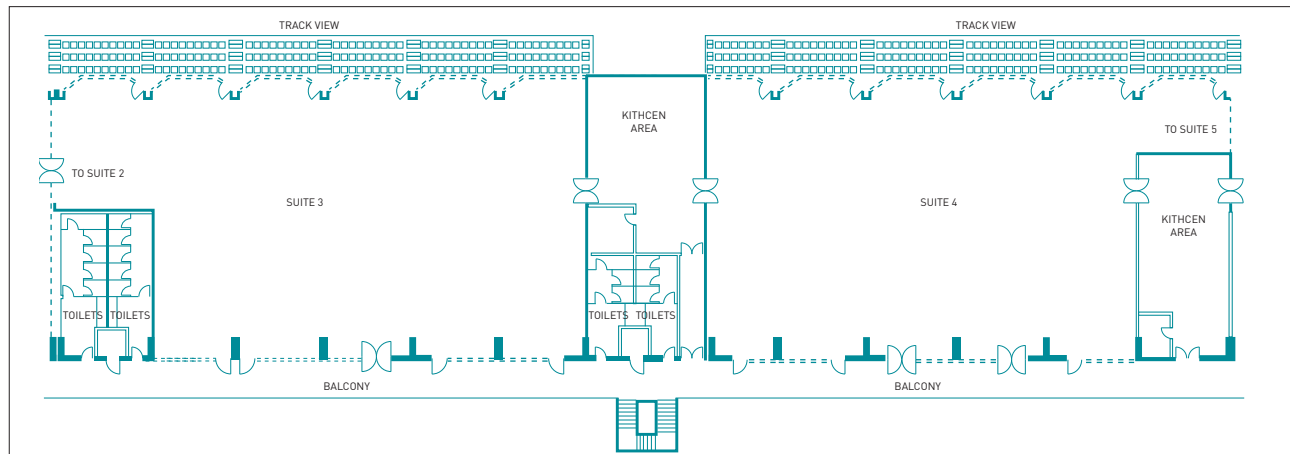
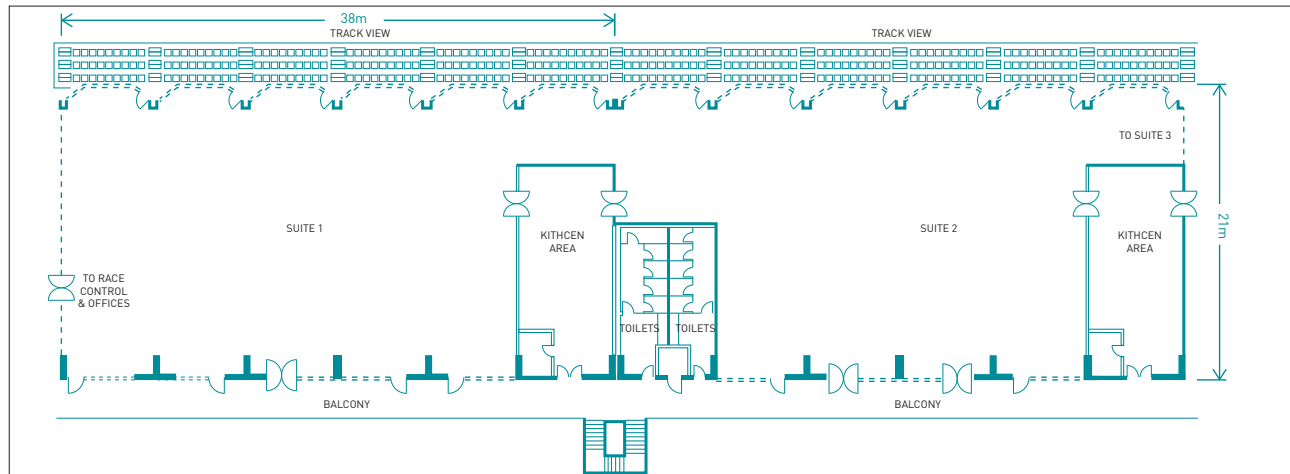

# YAS Events Paddock

## Paddock Suites

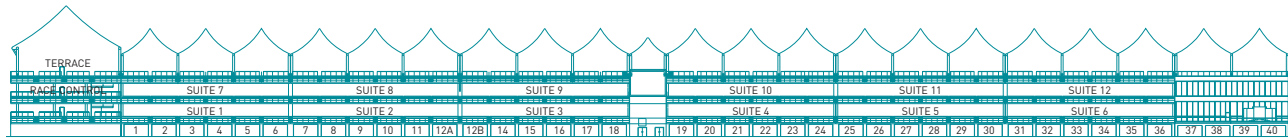

YAS EVENTS CENTRE	AREA M <sup>2</sup>	BANQUET 10	COCKTAIL	CLASSROOM	THEATRE	U-SHAPE	CABARET
SUITE 1	726	320	480	294	430	-	-
SUITE 6	783	260	575	216	406	-	-

### VENUE SPECIFICATIONS

- 12 corporate suites of varying sizes and layouts
- Fully equipped kitchen between each suite
- Lift and stairwell access
- Prayer rooms
- Track and Marina Views
- Rooftop terrace
- 2 suites with adjacent shaded outdoor terrace



[www.yasmarinacircuit.com](http://www.yasmarinacircuit.com) for more information.

